

PADS FOR SALE

CAMELBACK 83

NWC 83rd Ave & Camelback Rd | Glendale, AZ 85305

NEIL BOARD

602.778.3781
nboard@w-retail.com

BRYAN LEDBETTER

602.795.8670
bledbetter@w-retail.com

KATIE WEEKS

602.368.1372
kweeks@w-retail.com

WESTERN RETAIL ADVISORS

2555 E Camelback Rd, Suite 200
Phoenix AZ, 85016
602.778.3747 | w-retail.com

CAMELBACK 83 PADS

NWC 83rd Ave & Camelback Rd | Glendale, AZ



LOCATION DESCRIPTION

NWC 83rd Ave & Camelback Rd - Glendale

PROPERTY HIGHLIGHTS

- Fitness Anchored - EOS Fitness Coming Soon!
- PADS Available for Purchase, Ground Lease or Build to Suit
PAD A: 0.79; Acres PAD B: 0.87 Acres; PAD C: 1.18 Acres
- Densely Populated Area - 173 858 people within 3 miles & over 1,400 homes planned in the surrounding area
- Zoned - PAD - Commercial



AREA COTENANTS



The information contained within this brochure has been obtained from sources other than Western Retail Advisors, LLC. Western Retail Advisors have not verified such information and make no guarantee warranty or representation about such information. It is your responsibility to independently confirm its accuracy and completeness. Any dimensions, specifications, floor plans, and information may not be accurate and should be verified by you prior to the lease or purchase of the property.

CAMELBACK 83 PADS

NWC 83rd Ave & Camelback Rd | Glendale, AZ



The information contained within this brochure has been obtained from sources other than Western Retail Advisors, LLC. Western Retail Advisors have not verified such information and make no guarantee warranty or representation about such information. It is your responsibility to independently confirm its accuracy and completeness. Any dimensions, specifications, floor plans, and information may not be accurate and should be verified by you prior to the lease or purchase of the property.

CAMELBACK 83 PADS

NWC 83rd Ave & Camelback Rd | Glendale, AZ

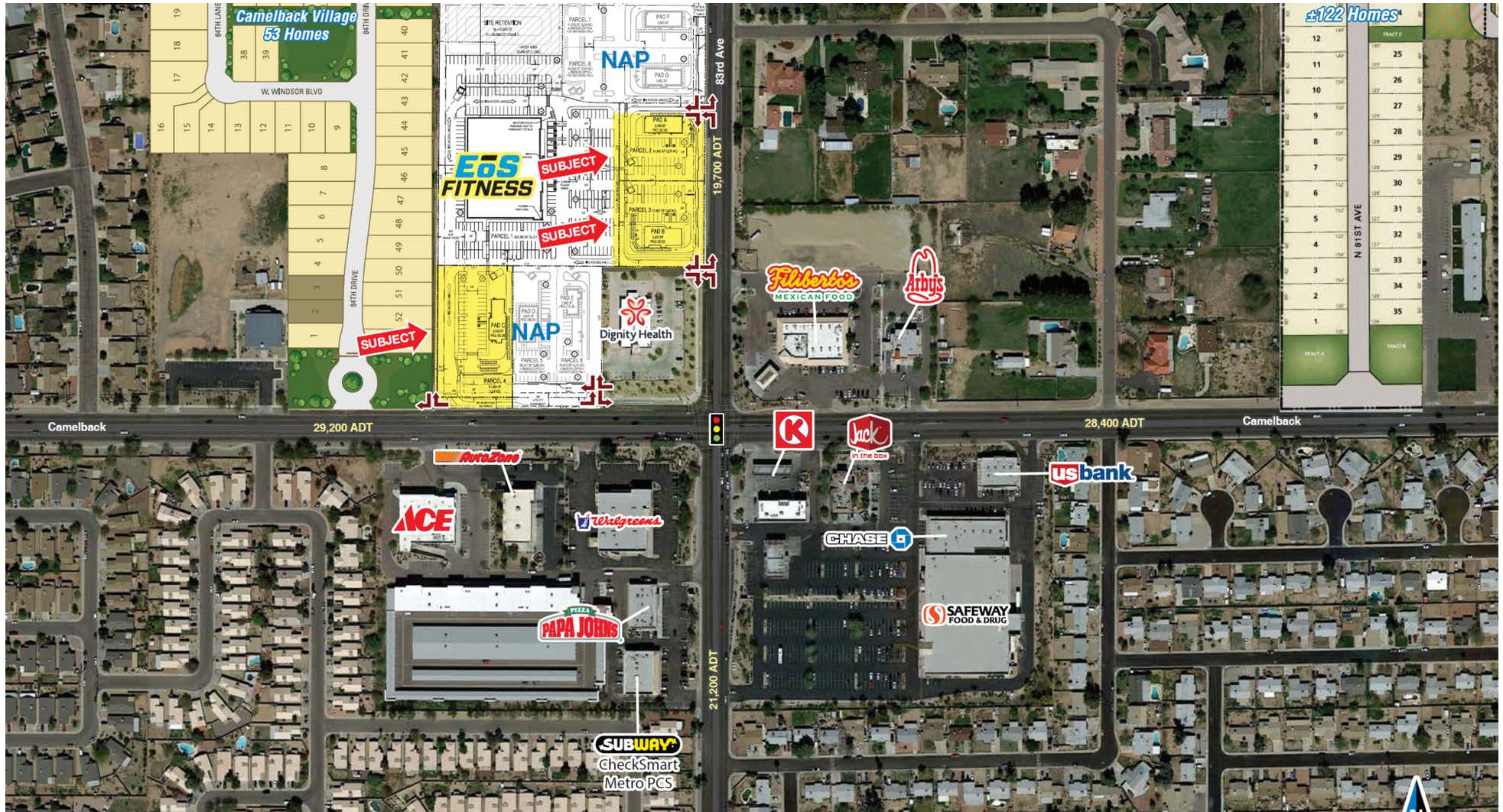

The information contained within this brochure has been obtained from sources other than Western Retail Advisors, LLC. Western Retail Advisors have not verified such information and make no guarantee warranty or representation about such information. It is your responsibility to independently confirm its accuracy and completeness. Any dimensions, specifications, floor plans, and information may not be accurate and should be verified by you prior to the lease or purchase of the property.

CAMELBACK 83 PADS

NWC 83rd Ave & Camelback Rd | Glendale, AZ

POPULATION SUMMARY	1 MILE	3 MILES	5 MILES
Total Population	21,826	173,858	383,4500
Total Population in 5 years	22,902	186,666	408,963
Annual Growth Rate	0.97%	1.43%	1.30%
Median Age	28.7	28.2	29.0
INCOME SUMMARY			
Median Household Income	\$47,940	\$47,494	\$44,529
Average Household Income	\$60,185	\$59,332	\$57,068
BUSINESS SUMMARY			
Total Businesses	141	1,939	6,419
Total Employees	1,029	24,289	91,503
Daytime Population	13,737	121,837	308,137
POPULATION 25+ by EDUCATIONAL ATTAINMENT			
Associate's Degree	8.5%	7.0%	6.8%
Bachelor's Degree	5.1%	7.9%	8.2%
Graduate / Professional Degree	3.3%	3.2%	3.6%
Percent of Population with Degrees	16.9%	18.1%	18.6%
EMPLOYED POPULATION 16+ by OCCUPATION			
Total	9,118	76,309	166,816
White Collar	45.2%	44.8%	45.4%
Service Industry	21.4%	23.1%	23.0%
Blue Collar	33.5%	32.1%	31.6%
HOUSEHOLD SUMMARY			
Households	5,784	48,011	113,053
Average Household Size	3.77	3.62	3.38
Average Family Size	4.06	4.03	3.90
Median Home Value	\$153,440	\$168,440	\$168,282

* 2020 Demographic data derived from ESRI

The information contained within this brochure has been obtained from sources other than Western Retail Advisors, LLC. Western Retail Advisors have not verified such information and make no guarantee warranty or representation about such information. It is your responsibility to independently confirm its accuracy and completeness. Any dimensions, specifications, floor plans, and information may not be accurate and should be verified by you prior to the lease or purchase of the property.